

SleepWeaver Advance Small - Quick Start Guide

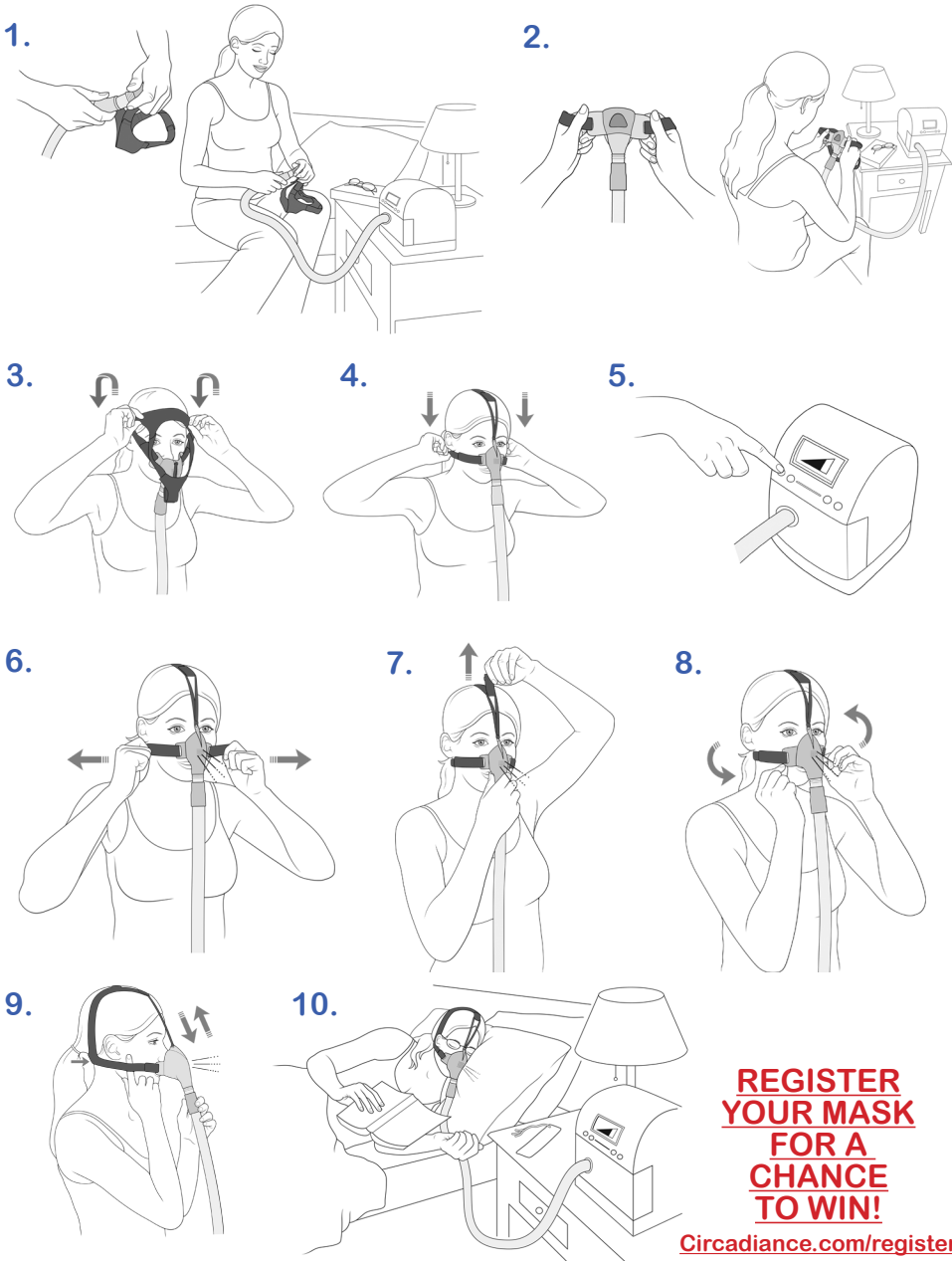

**REGISTER
YOUR MASK
FOR A
CHANCE
TO WIN!**

Circadiance.com/register

EC REP

EMERGO EUROPE
Molenstraat 15
2513 BH, The Hague
The Netherlands

CE
0459

101268 REV3
English

Circadiance

1060 Corporate Lane
Export, PA 15632 USA
Phone: 888-825-9640 or +1-724-858-2837
cservice@circadiance.com
www.Circadiance.com

SleepWeaver

Soft Cloth Nasal CPAP Masks

Advance Small

Instructions for Use



Introduction to Your Mask

Your SleepWeaver Advance Small Mask is attached to headgear, as shown above. The headgear has three adjustment points—one on each side of the mask and one on the Head Strap. A swivel connector attaches to the hose from your CPAP or bi-level machine.

Intended Use

The SleepWeaver Advance Small Nasal Mask is intended to provide an interface for Positive Airway Pressure (PAP) therapy. This mask is intended for single-patient reuse in the home and in the hospital/institutional environment. This mask is to be used on patients greater than 66 lbs (30 kg).

Fitting the Mask

1. Remove your SleepWeaver Advance Small Mask from the packaging.
2. Connect the tubing from your CPAP or bi-level machine to the Swivel Connector on the front of the mask.
3. Turn on your CPAP or bi-level machine at your prescription pressure.
4. When the mask inflates, hold the headgear with both hands, position the mask on your nose, and pull the headgear over your head. Make sure that the cup of the mask is centered over your nose, and align the Head Strap to the center of your head.
5. Pull the headgear over the back of your head until the Neck Strap is snug just below your ears.
6. If you experience leaks, please refer to the "Adjusting for Leaks" section.
7. Lie down in your normal sleeping position. If any leaks occur, readjust the mask.

Adjusting for Leaks

- If you experience leaks, try these steps:
1. With your CPAP or bi-level machine on and at your prescription pressure, pinch the portion of the mask directly over your nose, pull the mask slightly away from your face, towards your feet, and gently release.
 2. If you experience leaks from the sides of the mask, adjust the Neck Straps by unhooking the tab from the strap and pulling the straps out to tighten the mask, then re-attach the tab to the strap.
 3. If you experience leaks into your eyes, adjust the Head Strap.
 4. At times it is possible to stop leaks and get a better fit by loosening the mask just a bit, then repeating Step 1.
 5. Leaks can also occur if the headgear straps are too tight or too loose. With practice you should find the snug but comfortable fit that works for you.

Cleaning the Mask

1. Your SleepWeaver Advance Small should be cleaned by hand washing with a mild nonabrasive soap in warm water every other day. Never use hot water. Repeat washing until visibly clean. Hand wash the headgear weekly.
2. Rinse well with drinking quality water and allow to air dry out of direct sunlight.
3. Your SleepWeaver Advance Small mask can be cleaned using Control III® (Follow the manufacturer's instructions) NOTE: This is NOT a validated disinfecting method.

SleepWeaver Advance Small Mask & Headgear

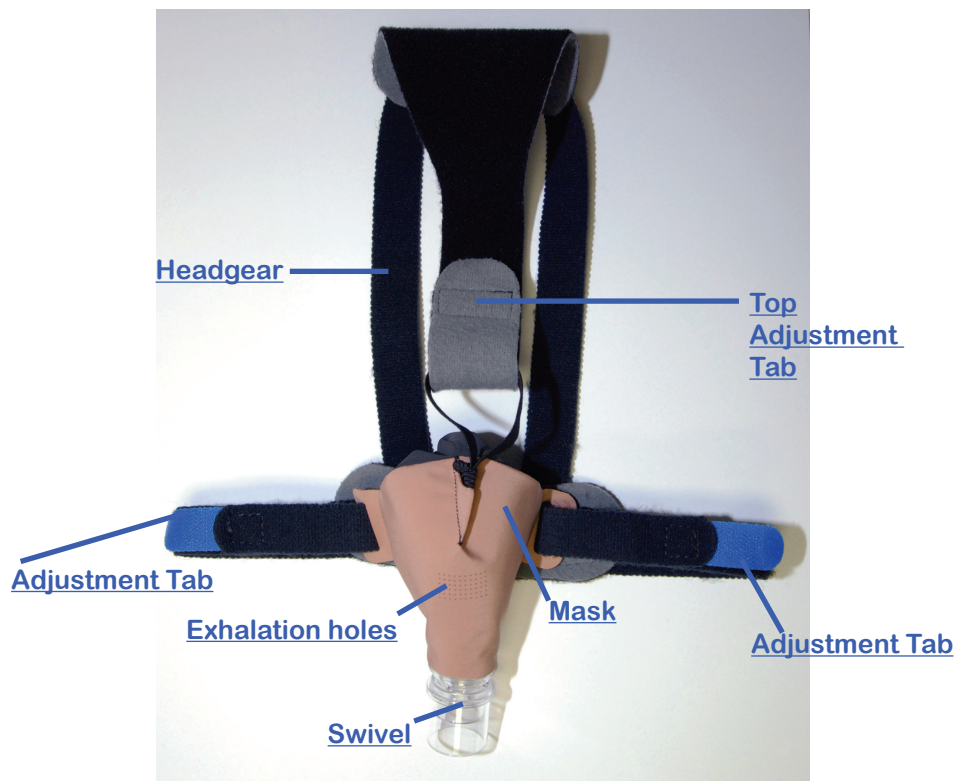

Exhalation Valve

There is no jet of air with exhalation. Venting is through a series of small pinholes. The flow through the exhalation valve plus leaks from the swivel and other sources is:

[Exhalation holes](#)



Technical Specifications

1. Therapy pressure range
4 to 20 cm H₂O
3. Resistance (pressure drop)
@ 50 l/min = 0.4 cm H₂O
@ 100 l/min = 0.9 cm H₂O
4. Fixed leak rate (flow may vary due to manufacturing variation):

Pressure(cmH2O)	4	5	10	15	20
Flow (lpm)	17	19	29	37	45

5. Environmental storage and operating conditions are not expected to effect the function of this device.

Sound Levels

A-weighted Sound Power Level 26 dBA

A-weighted Sound Pressure Level at 1 m 18 dBA

⚠ Cautions & Warnings

- Does not contain natural rubber latex. If you have any reaction to any part of this mask or headgear discontinue use immediately.
- In the USA, federal law restricts this device to sale by, or on the order of, a physician.
- This system should be used only with CPAP or bilevel systems recommended by your physician or respiratory therapist.
- This mask should not be used unless the CPAP or bi-level system is turned on and operating properly.
- The vent holes should never be blocked.
- Please refrain from smoking while using this product
- The SleepWeaver Advance Small should not be cleaned with unapproved cleaning and disinfecting methods.
- The mask should be cleaned daily to prevent dirt and oil contamination from the skin building up on the mask.
- The patient should clean their face prior to wearing the mask.
- The patient should not alter the design of the mask.
- Do not place the mask in a clothes dryer.
- If the SleepWeaver Advance Small is being used with supplemental oxygen, the oxygen flow must be turned off if the machine is not operating because accumulated oxygen is a fire hazard.
- If the SleepWeaver Advance Small is being used with supplemental oxygen, the patient should refrain from smoking.
- The SleepWeaver Advance Small is for single patient re-use only and is not approved for clinical cleaning and disinfecting methods.
- At low pressures the flow through the ventilation holes may be inadequate to clear all exhaled gas from the tubing. Some rebreathing may occur.

Limited Warranty

- www.circadiance.com/help